

FOR LEASE

2084 LAKE INDUSTRIAL COURT

2084 LAKE INDUSTRIAL COURT :: CONYERS, GA 30013

- Rear load configuration
- M-1 zoning (light industrial)
- 90,000 SF of air conditioned warehouse



LOCATION MAP



FOR MORE
INFORMATION
PLEASE
CONTACT

Trey Barry
Senior Associate
404.923.1340
trey.barry@cbre.com

Jeff Henson
Associate
404.923.1437
jeff.henson@cbre.com

	Suite A	Suite B
Available:	120,000 SF	60,000 SF
Office space:	17,818 SF	0 SF
Total building size:	180,000 SF	
Clear height:	28'	
Column spacing:	40' x 50'	
Dimensions:	300' x 600'	
Truck doors:	24 dock-high, 1 drive-in, knock out panels	
Truck court:	130' depth	
Sprinkler:	ESFR	
Lighting:	Metal halide / T5	
Parking:	200 auto spaces	
HVAC	60,000 SF	
Power:	1600 amps at 277/480 volts	



FOR LEASE



2084

LAKE INDUSTRIAL COURT

CONYERS, GA

180,000 SF

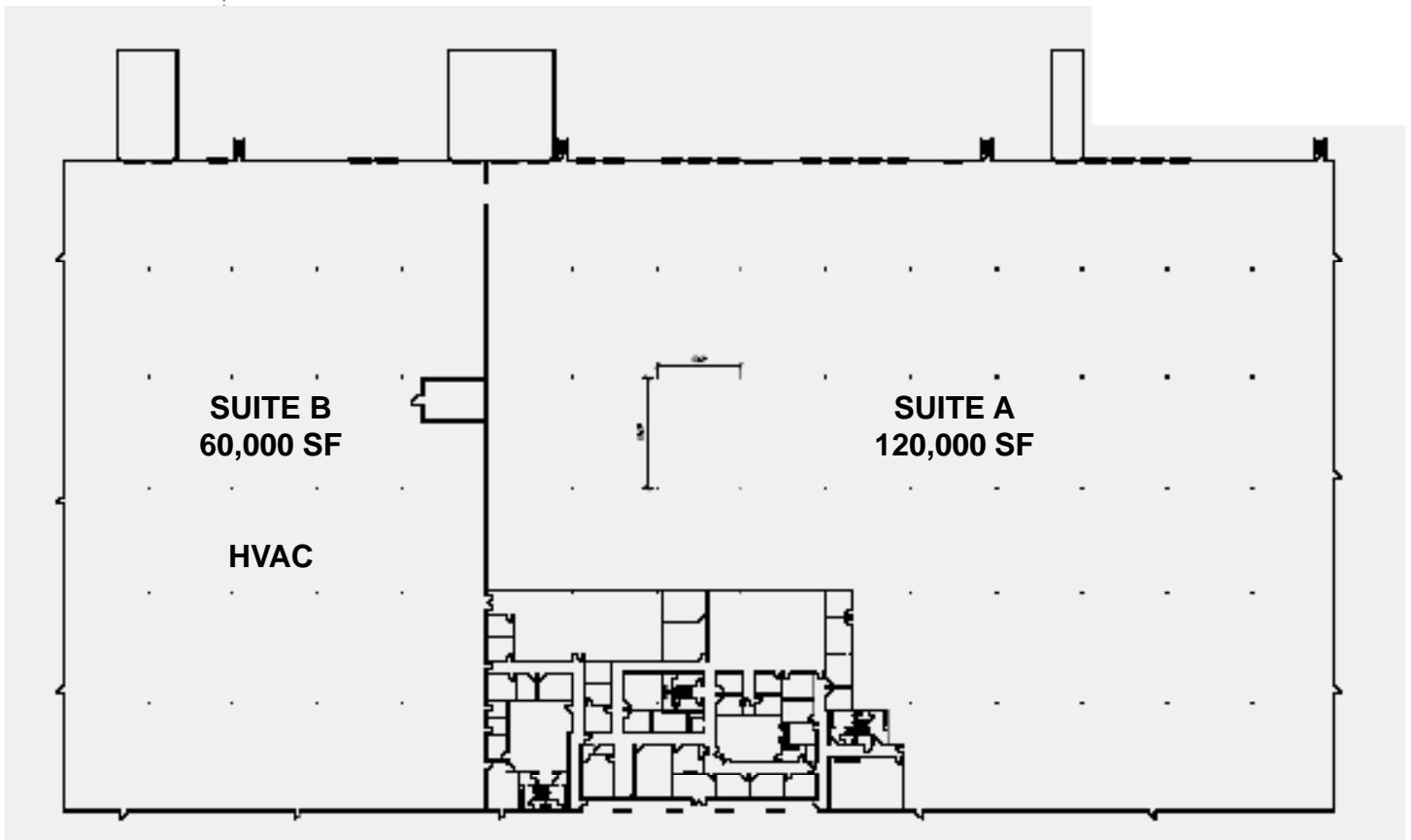

FOR MORE
INFORMATION
PLEASE
CONTACT

Trey Barry

Senior Associate

404.923.1340

trey.barry@cbre.com

Jeff Henson

Associate

404.923.1437

jeff.henson@cbre.com



CBRE

CB Richard Ellis | 404.504.7900 | 3280 Peachtree Rd. | Suite 1400 | Atlanta, GA 30305 | www.cbre.com/atlanta

© 2011 CB Richard Ellis, Inc. This information has been obtained from sources believed reliable. We have not verified it and make no guarantee, warranty or representation about it. Any projections, opinions, assumptions or estimates used are for example only and do not represent the current or future performance of the property. You and your advisors should conduct a careful, independent investigation of the property to determine to your satisfaction the suitability of the property for your needs.